



Dofunit Assembly Manual

Contents:

1. General
2. Main parts
3. Instructions

*Dedicated to the sport of dog driving,
Dofunit, The Next Step in Dog Driving Evolution*



General

1. Dofunit is a simple to build cart, made of steel and aluminum. To make worldwide shipping as affordable as possible, some of the assembly process is left for you, the customer.
2. A metric Allen key set, a screw driver and an adjustable wrench will basically be all you need.
3. Make it a habit to work safely. Be sure to acquire (and use) all the proper safety gear for the job.
4. We made an effort to keep this manual as simple as can be. However, if there is any doubt or question, please don't hesitate to email us or contact us through our Facebook page. A wise man once said – while people don't always take the time to do a good job once, they usually have to find the time to do it twice. Be smart. We are here at your service.
5. We strongly advise you go to your local bicycle store to assemble the brake calipers and cables. If you are not a professional, you might not know how to do it the right way, resulting in a safety issue. Dofunit's dual disc brake system looks and acts exactly the same as in any regular bicycle and should take your friendly local bicycle mechanic no more than ten minutes to put together. We refrained from explaining how to assemble the brakes, to make sure you do not try doing it yourself unless you already have the experience and can do it correctly.

***Dedicated to the sport of dog driving,
Dofunit, The Next Step in Dog Driving Evolution***



6. When you receive your new Dofunit, the chassis, front panel and seat rail, seat clamp and the special reinforcement plate are already assembled. We did that because it is essential for your safety that these parts are correctly put together.
7. What is left for you to put together are the seat, axles, wheels and brakes, add the shaft and you are good to go.
8. First thing – read this manual all the way to the end before you start your assembling project. Only then, take out all parts from the different boxes, unpack them and make sure you identify all parts big and small. Gather all the tools you are going to need. Get a few bowls for bolts, nuts, washer and all other little yet important likely-to-disappear parts.

***Dedicated to the sport of dog driving,
Dofunit, The Next Step in Dog Driving Evolution***

Main parts



Chassis

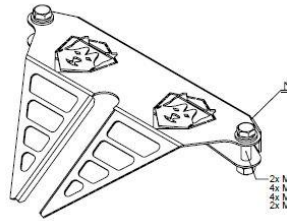

Front panel

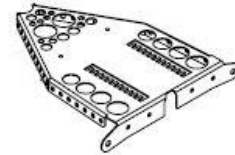

Seat rail

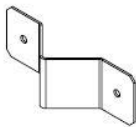

Seat rail clamp

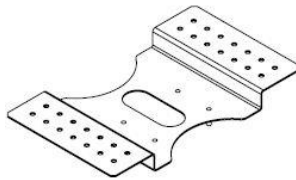

Seat base

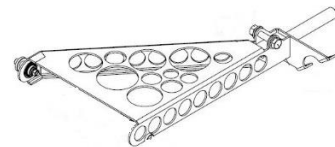

Axle (left and right)

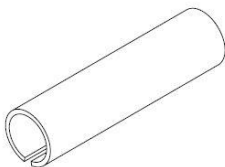

Yoke sleeve

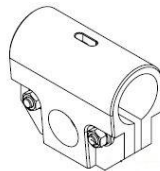

Shaft clamp



Foot rest



Shaft



Brake handle



Shocks

*Dedicated to the sport of dog driving,
Dofunit, The Next Step in Dog Driving Evolution*

Assembly instructions

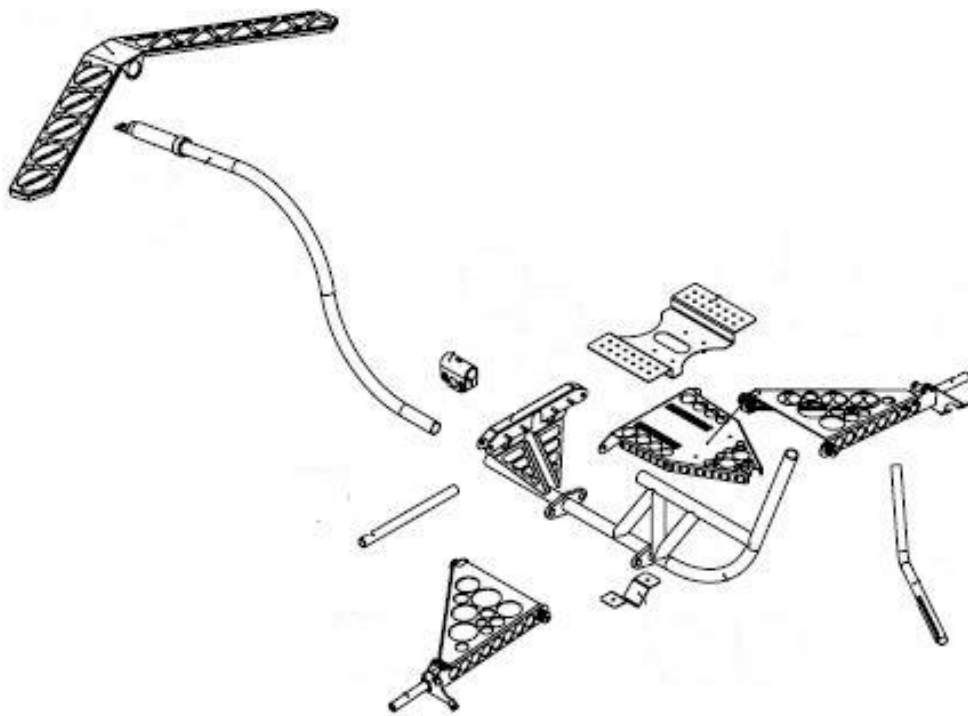

1. The most delicate and time-consuming part to assemble might be the axles. Each axle is held by two hinges, each made of five little parts, with a bolt going through them all. It is best if you could ask someone to help with those, as it is far easier doing it with four hands rather than two.

***Dedicated to the sport of dog driving,
Dofunit, The Next Step in Dog Driving Evolution***

2. As previously said, each of the axles is held by two hinges, each made of five little parts, with a bolt going through them all. Two of these five little parts are already fitted in the axles: the bearing and bearing bushing.
3. Before anything else, make sure you know which of the two is the right axle and which is the left one.
4. Put your Dofunit upside down on your working bench or on the floor. Insert the bushing (1) from the outside in, on both sides. Then, from the inside of the black chassis part, put the two spacers on the bushings – the wider on the front side bushing, the narrower on the back-side bushing. Gently push the bushings back out so they do not outstand the spacer's width. The axle's width is exactly the length between those spacers– if they outstand inwards, you won't be able to squeeze the axle in between them. This is where a third and fourth hand might be very handy.

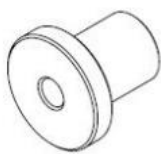

Bushing (1)



Spacer



Bushing (2)

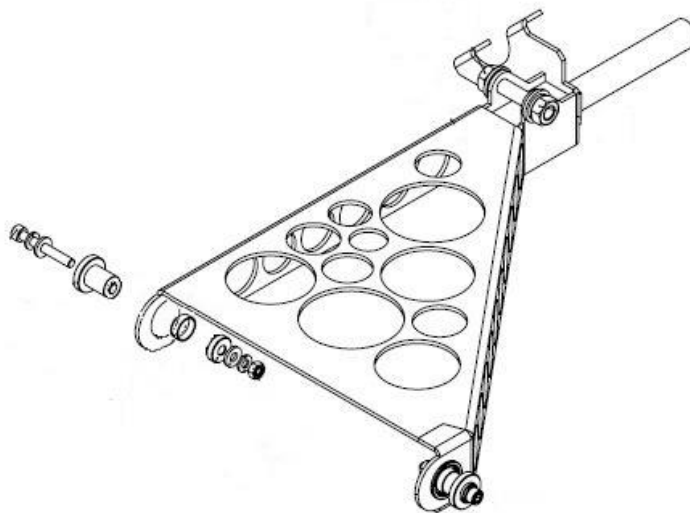

Left axle

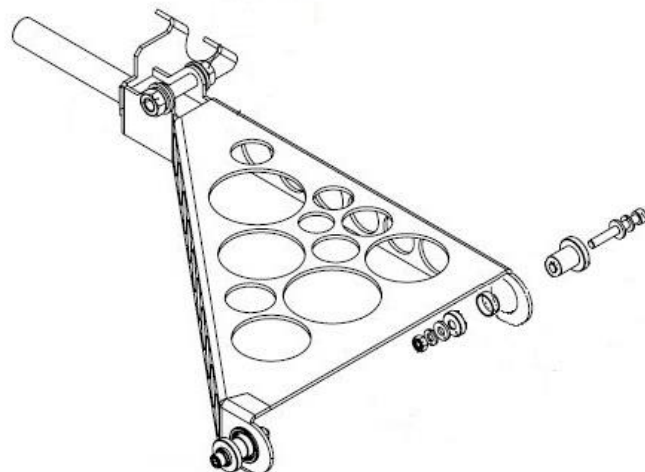

Right axle

***Dedicated to the sport of dog driving,
Dofunit, The Next Step in Dog Driving Evolution***



5. Ask your assistant to gently place the axle in its position, between the two bushings. Make sure you are assembling the correct one, and that it is facing up, not down. If you did it right, the right angle of the axle is facing backwards.
6. Once the bushing (1) is in, spacer on bushing, and axle is placed –push bushing (1) all the way back into the axle from both sides in.
7. Bottom line, order of parts, outside in, is: washer, bushing (1), (black) chassis, spacer, (red) axle, bushing (2), washer. Bolt and nut. You did very well! Now do the other side – assemble it exactly the same way.
8. Put bushing (2) facing bushing (1) from the inside, insert the bolt through the whole thing from the outside in (using washers head and tails) and finish with a locking nut. Tighten, but don't over do it. You want the chassis to move up and down easily.
9. Once both axles are in place, you can assemble the shocks. A big bulky 10mm X 50mm bolts are used on both sides – one on the upper side of the front panel, the other on the far end of the axle. Insert the bolts from the front backwards. Do not tighten the nuts too much not to close the steel sides on the shocks. There are plastic covers for the bolts – we recommend you glue them to the bolts, not to lose them later.
10. Brake handle should be attached to the right side of the seat rail with two 25mm bolts. Use washers on both sides, lock with nuts from the inside.

***Dedicated to the sport of dog driving,
Dofunit, The Next Step in Dog Driving Evolution***



11. You or your friendly bicycle mechanic will now put on the wheels, ending with a 22mm washer and a bolt that goes into the axle. After doing so, the brake calipers go to their place on both sides, cables from the dual handle to calipers, some fine adjustments and your Dofunit is ready to roll.
12. The front end of the chassis, as well as the back end of the shaft have both little matching slots. The clamp that holds them together has a little hole on top. This was made so you know, while assembling your shaft, that you aligned them correctly. This, however, is fine tuning. Third time you put the shaft together you really won't need it anymore.
13. While tightening the clamp bolts you will notice your adjustable wrench cannot fit in, and you might think there is no way to hold the nut while turning the bolt. This, of course, is not the case. Remember we asked you to get a screw driver, even though there are no screws on the Dofunit? If you stick your screw driver next to the nut, you prevent it from turning and can now use your Allen key to easily tighten the bolt on the shaft.
14. Your new Dofunit is based on balance. When you sit on it, the far tip of the shaft has to pull the dog slightly UPWARDS. To achieve the correct balance, the seat is mounted on a rail, with four bolts going downwards, tightened by easy to turn plastic nuts. Lighter people would need to pull the seat backwards by turning the nuts loose, sliding the seat a bit left thus releasing it from the rail teeth, pushing backwards, sliding back in to the right and tightening the nuts. Once you find the correct balance for you, no need to play with it again.

***Dedicated to the sport of dog driving,
Dofunit, The Next Step in Dog Driving Evolution***



15. When using a single dog, keep the yoke sleeve at home so it doesn't get lost. For a two-dog team, put the sleeve back on, add the yoke on it and secure with the quick release seat post clamp in front of it.

16. Your Dofunit is ready to use. Make sure you and your dog are ready to go driving. Time to go. Drive safely and have fun!

If you need us, you can email us to arie@dofunit.com, find us on Facebook, or check on us at Dofunit.com.

***Dedicated to the sport of dog driving,
Dofunit, The Next Step in Dog Driving Evolution***

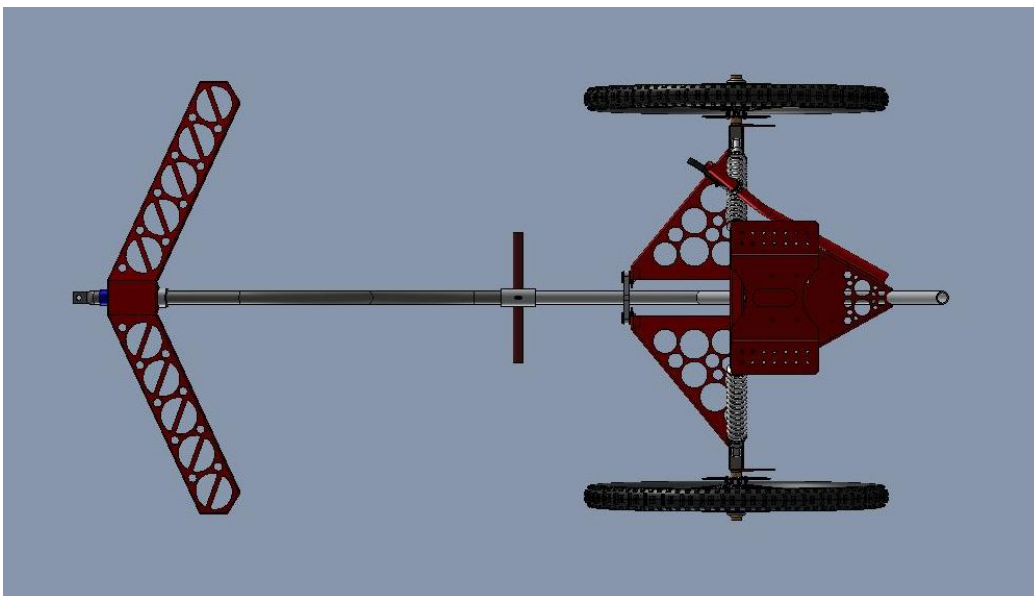
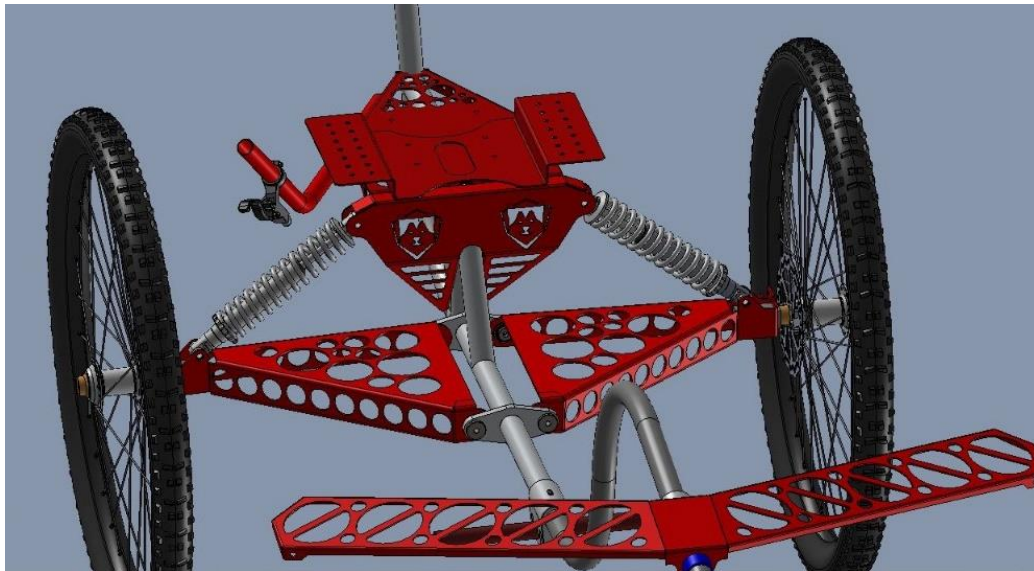
A 3D side-view rendering of the same red metal sled chassis. This view highlights the side profile of the red frame, the two large black wheels, and the central silver-colored axle. The red handlebar and footrest are also visible from this angle. The background is a plain light blue.

*Dedicated to the sport of dog driving,
Dofunit, The Next Step in Dog Driving Evolution*

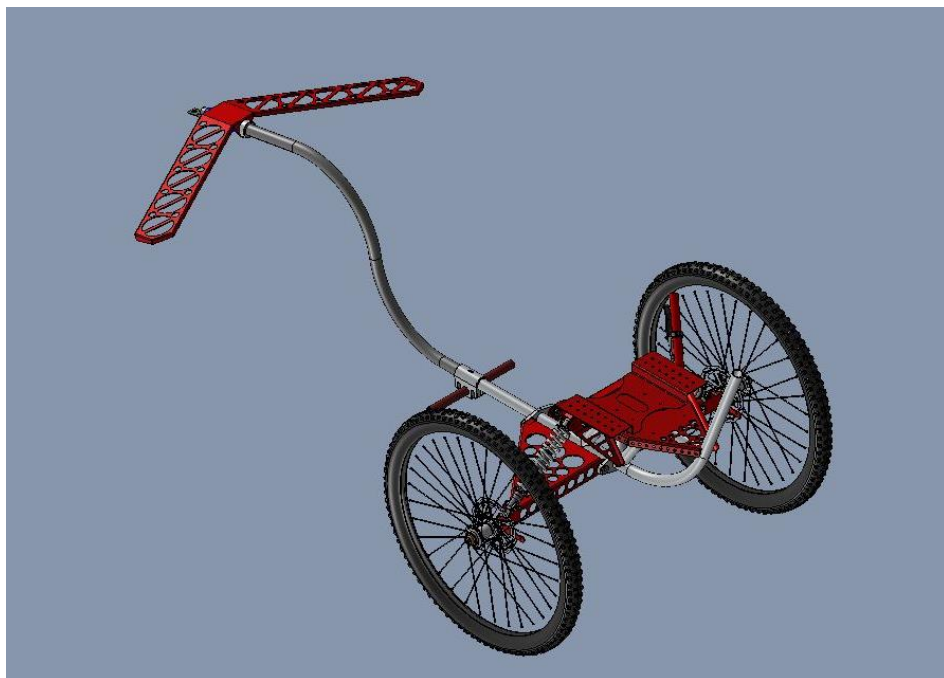

***Dedicated to the sport of dog driving,
Dofunit, The Next Step in Dog Driving Evolution***

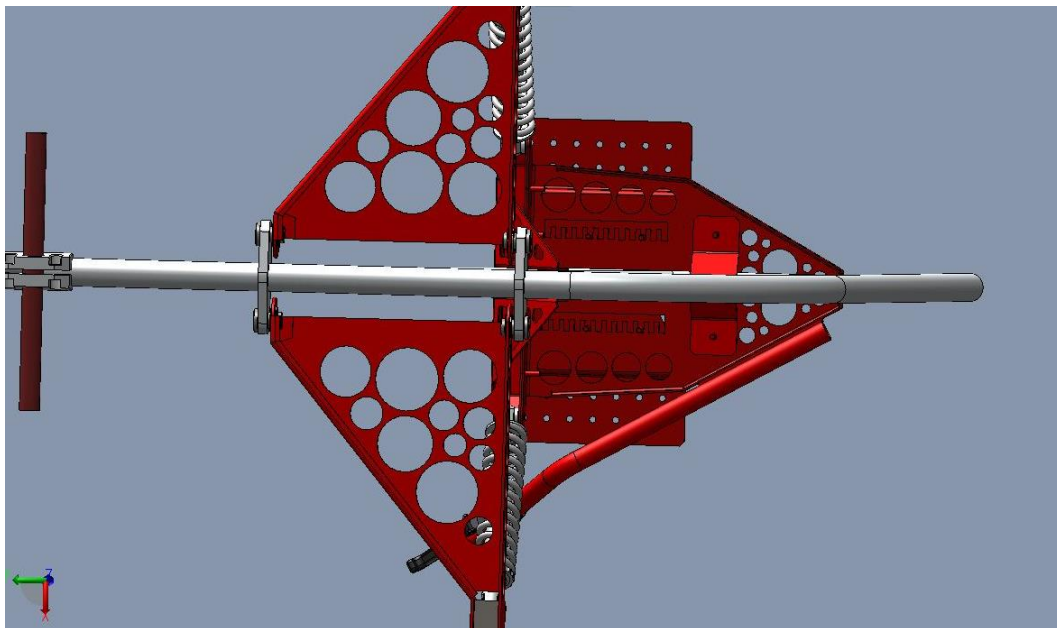
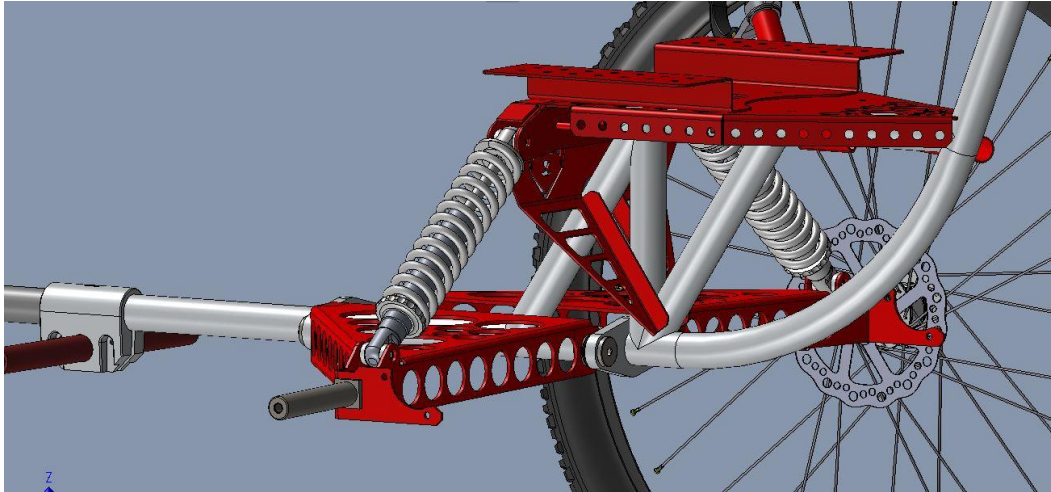

*Dedicated to the sport of dog driving,
Dofunit, The Next Step in Dog Driving Evolution*

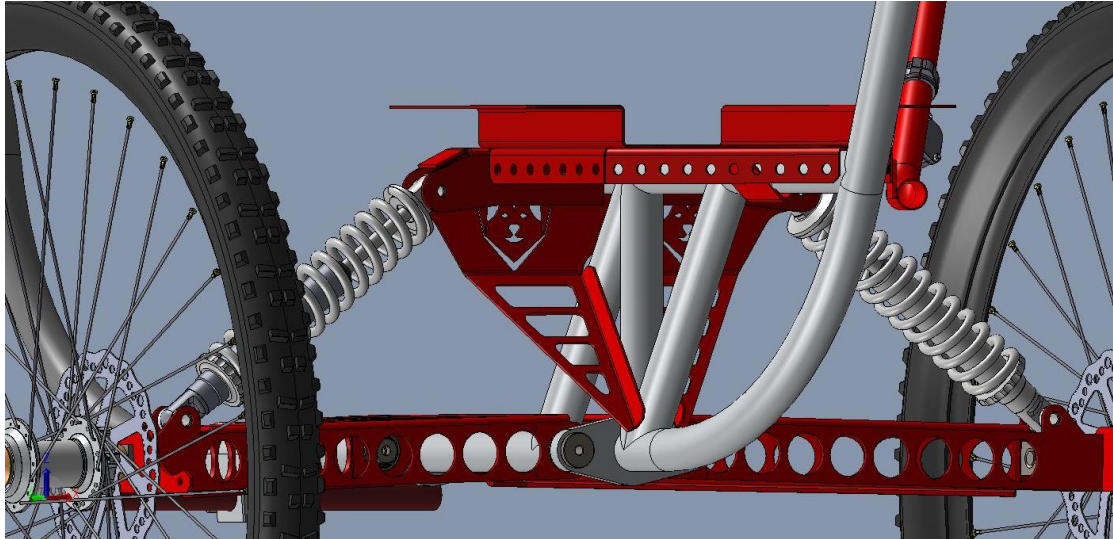

***Dedicated to the sport of dog driving,
Dofunit, The Next Step in Dog Driving Evolution***

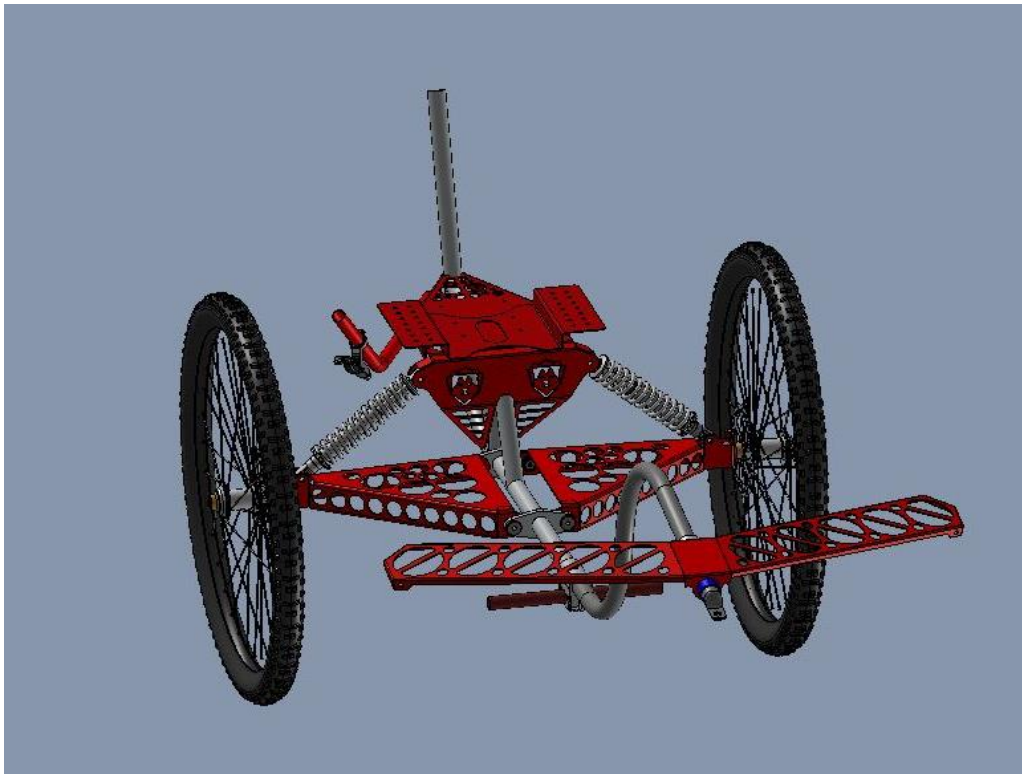

*Dedicated to the sport of dog driving,
Dofunit, The Next Step in Dog Driving Evolution*